

NOTES:
 1. THIS DRAWING IS TO BE READ IN CONJUNCTION WITH THE ALUMINIUM SCHEDULE'S GENERAL NOTES & "GENERAL SPECIFICATION OF BUILDING WORK" (REF: R2858-E-A1-902 & R2858-E-A1-905).
 2. ALL WATERPROOFING DETAILS TO BE CO-ORDINATED BETWEEN THE CONTRACTOR, WATERPROOFING SPECIALIST AND ALUMINIUM MANUFACTURER, IN REFERENCE TO THE ARCHITECT'S WATERPROOFING DETAILS.
 3. THE ALUMINIUM MANUFACTURER WILL BE DEEMED RESPONSIBLE TO ENSURE ALL PERIMETER WATERBARRIERS (DPC/ WATERPROOFING ANGLES) ARE INSTALLED IN POSITION, BEFORE INSTALLATION OF WINDOWS AND DOORS.
 THE ARCHITECT/PRINCIPLE AGENT MUST BE INFORMED IMMEDIATELY SHOULD THIS NOT BE THE CASE.

ALL STATUTORY REQUIREMENTS (NATIONAL BUILDING REGULATIONS AND MUNICIPAL BY-LAWS) MUST BE ADHERED TO. • CONTRACTORS ARE TO CHECK AND VERIFY ALL DIMENSIONS AND LEVELS ON THE BUILDING SITE BEFORE WORK COMMENCES. • FIGURED DIMENSIONS AND LARGE SCALE DETAIL TAKES PREFERENCE OVER SCALED DIMENSIONS. • REFER ANY AND ALL CONFLICTING INFORMATION TO THE ARCHITECT AND OTHER RESPONSIBLE CONSULTANTS THE DESIGN AND DETAIL ON THIS DRAWING IS THE PROPERTY OF TV3 ARCHITECTS AND TOWNPLANNERS (PTY) LTD, AND COPYRIGHT IS RESERVED.

DRAWING STATUS CODES:
A: Design • **B:** Marketing • **C:** Municipal • **D:** Tender • **E:** Construction • **F:** As Built

PROJECT DESCRIPTION:

**Proposed New Retirement Estate, ARUN Properties
 Erf 24698 - De Plattekloof
 DRAWING DESCRIPTION:
 APARTMENT A1 - UNIT 05**

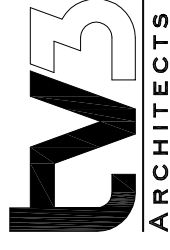

First Floor • La Gratitude Office Building
 97 Dorp Street • Stellenbosch 7600
 tel (021) 861 3800
 fax (021) 882 8025
 e-mail: ste@tv3.co.za
 web: www.tv3.co.za

DRAWN: Kobus Louw (SACAP Cant 3119)
 CHECKED: Kalla Smit
 DATE: 19-01-2016 | SCALE/SHEET SIZE: 1:25/A3
 DRAWING No.: R2858-E-A1-2505

REVISION:
A